



From the moment you enter, the lobby sets the tone for an elevated lifestyle. Designed with a contemporary palette of marble finishes, golden accents, and warm lighting, the double-height space exudes modern grandeur.

A bespoke reception counter, artistic wall panels, and curated greenery create a serene yet striking ambiance. Elegant seating, designer elements, and a sculptural centerpiece complete the experience, making the lobby not just a transitional space, but a stylish statement of arrival.



AMENITIES

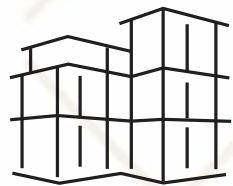

RCC Frame structure
as per seismic standard



Exquisite vitrified / granamite
tile flooring in all rooms

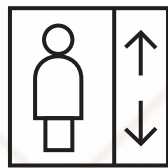

Reputed elevator



GYMNASIUM



CARROM

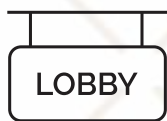

Entrance Lobby



Adequate light / power point
using modular switches



Colour Anodized aluminum
sliding windows



CHESS



JOGGING TRACK



Designer main door



Designed ceramic tile flooring
& Dado up to door height in toilet
with latest bath fittings

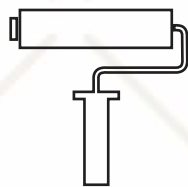

Acrylic or equivalent paint
on external surface of building



TABLE TENNIS

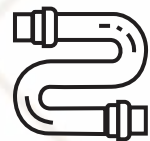

Concealed plumbing with
and cold water in all toilets
and Branded C. P. Fittings



Earthquake resistant
structure



Kitchen platform with Granite
top & S. S. sink and Ceramic
tiles up to door height
above kitchen platform

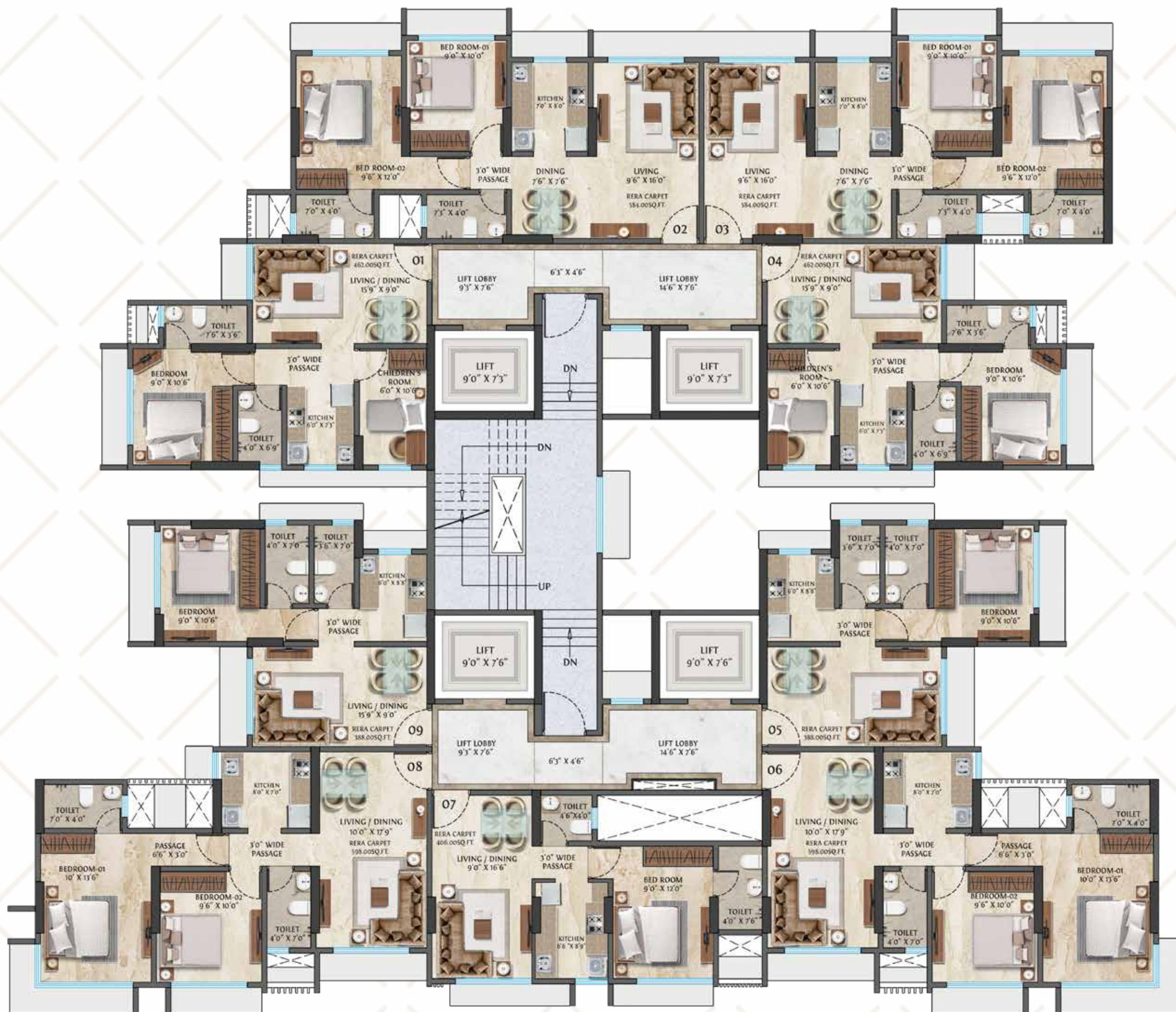

TYPICAL FLOOR PLAN

It's all in the name! Somani 72 East is a unique concept where all aspects of decision making, when you pick up a real estate, come full circle.

Be it the excellence in design, the centrality of location, the sense of details, the luxurious features.

Somani 72 East makes life easy and wonderful. At Somani 72 East we have all these integrated into an overing of fine living.

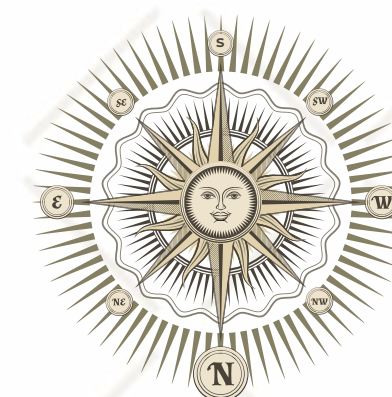

ISOMETRIC VIEW



GRAND - 2BHK

RERA CARPET : 584 Sq. Ft.



ELITE - 1.5BHK

RERA CARPET : 462 Sq. Ft.



APEX - 1BHK

RERA CARPET : 388 Sq. Ft.